

MT

Nut-style tensioner standard

MT tensioners fit in the same space as a heavy hex nut and feature hex-head jackbolts. They're suited for use on general mechanical applications.

Components:
1 Nut body
2 Jackbolts
3 Hardened washer

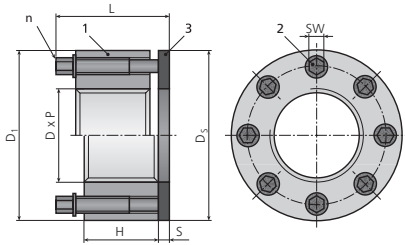

Metric	Size			Nut body		Jackbolt		Hardened washer		Height	Weight	Preload*	Torque*	Preload capacity*	
	Thread	Available pitch			1	2	3	tot	est	nom	nom	max			
Part number	D	P ₁	P ₂	P ₃	D ₁	H	n	SW	D _s	S	L	F	M		
	[mm]	[mm]			[mm]	[mm]		[mm]	[mm]	[mm]	[mm]	[kg]	[kN]	[Nm]	[kN]
MT-M16x.../W	M16	2	1.5	1	34	16	4	5	32	3	33	0.11	73	14	94
MT-M20x.../W	M20	2.5	1.5	1	38	16	6	5	38	4	34	0.14	110	14	140
MT-M22x.../W	M22	2.5	1.5	1	41	16	6	5	41	4	34	0.16	110	14	140
MT-M24x.../W	M24	3	2	1.5	44	16	8	5	43	4	34	0.19	145	14	185
MT-M27x.../W	M27	3	2	1.5	50	24	6	6	50	5	45	0.35	215	36	285
MT-M30x.../W	M30	3.5	2	1.5	53	24	6	6	53	5	45	0.37	215	36	285
MT-M33x.../W	M33	3.5	2	1.5	59	24	8	6	59	5	45	0.48	285	36	380
MT-M36x.../W	M36	4	3	1.5	66	32	6	8	66	5	57	0.76	345	72	460
MT-M39x.../W	M39	4	3	1.5	70	32	8	8	70	5	57	0.90	455	72	610
MT-M42x.../W	M42	4.5	3	1.5	75	32	8	8	73	5	57	1.01	455	72	610
MT-M45x.../W	M45	4.5	3	1.5	83	38	8	10	81	6	68	1.48	700	131	935
MT-M48x.../W	M48	5	3	1.5	85	38	8	10	85	6	68	1.50	700	131	935
MT-M52x.../W	M52	5	3	2	94	38	8	10	89	6	68	1.80	700	131	935
MT-M56x.../W	M56	5.5	4	2	100	38	8	10	95	6	68	2.00	700	131	935
MT-M60x.../W	M60	5.5	4	2	107	38	10	10	100	6	68	2.30	875	131	1170
MT-M64x.../W	M64	6	4	2	113	53	8	14	112	8	92	3.65	1270	315	1690
MT-M68x.../W	M68	6	4	2	117	53	8	14	117	8	92	3.85	1270	315	1690
MT-M72x.../W	M72	6	4	2	120	56	8	14	120	8	92	4.00	1270	315	1690
MT-M76x.../W	M76	6	4	2	132	56	12	14	127	8	92	5.10	1900	315	2530
MT-M80x.../W	M80	6	4	2	132	56	12	14	127	8	92	4.80	1900	315	2530
MT-M85x.../W	M85	6	4	2	137	56	12	14	137	8	92	5.10	1900	315	2530
MT-M90x.../W	M90	6	4	2	145	59	16	14	140	8	99	6.00	2530	315	3380
MT-M100x.../W	M100	6	4	2	164	61	16	14	152	8	99	7.80	2530	315	3380
MT-M110x.../W	M110	6	4	2	177	79	12	17	172	10	125	11.40	3150	645	4200
MT-M120x.../W	M120	6	4	2	189	81	16	17	179	10	125	13.00	4200	645	5600
MT-M125x.../W	M125	6	4	2	194	81	16	17	190	10	125	13.50	4200	645	5600
MT-M130x.../W	M130	6	4	2	205	94	18	17	202	10	140	17.50	4700	645	6300
MT-M140x.../W	M140	6	4	2	215	94	20	17	215	10	140	18.70	5250	645	7000
MT-M150x.../W	M150	6	4	2	225	94	20	17	225	12	142	20.00	5250	645	7000
MT-M160x.../W	M160	6	4	-	234	107	24	17	234	12	162	24.10	6300	645	8400

* All preload and torque values are provided for general reference. Applied preload plus additional bolt load from service should not exceed the maximum bolt or stud capacity. Contact your local Nord-Lock sales office for assistance in determining proper preload and torque settings for your application.

- Other sizes, thread pitches or thread per inch (TPI) may be available.

- Dimensions listed are representative.

©Copyright 2018 Nord-Lock Group. NORD-LOCK, SUPERBOLT, BOLTIGHT and EXPANDER SYSTEM are trademarks owned by different companies within the Nord-Lock Group. All other logos, trademarks, registered trademarks or service marks used herein are the property of the Nord-Lock Group. All rights reserved.