

SB8

Bolt-style tensioner standard

SB8 bolt-style tensioners are most often used for applications with tapped holes. The diameter of the bolt-style tensioner head is smaller than a nut-style tensioner, so bolt-style tensioners can fit tighter spaces. They feature an external installation/removal hex.

Components:
1 Bolt body
2 Jackbolts
3 Hardened washer

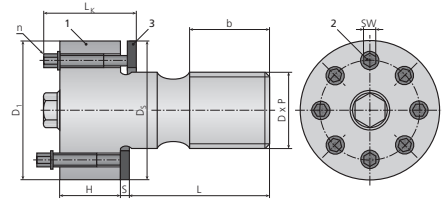

Imperial Part number	Size			Bolt body		Jackbolt		Hardened washer		Height	Preload*	Torque*	Preload capacity*	
	Thread D [in]	Available TPI P ₁ P ₂ P ₃			D ₁ [in]	H [in]	n	SW [in]	D _s [in]	S [in]	tot L _k [in]	nom F [LBf]	nom M [Lbft]	max [LBf]
SB8-075-...x.../W	3/4	10	16	-	1.35	0.70	4	3/16	1.35	0.13	1.38	20,400	14	27,100
SB8-087-...x.../W	7/8	9	14	-	1.48	0.70	6	3/16	1.48	0.13	1.38	30,600	14	40,700
SB8-100-...x.../W	1	8	12	14	1.59	0.70	8	3/16	1.59	0.13	1.38	40,800	14	54,200
SB8-112-...x.../W	1-1/8	7	8	12	1.83	0.90	6	1/4	1.83	0.16	1.68	48,600	27	63,600
SB8-125-...x.../W	1-1/4	7	8	12	1.98	0.90	8	1/4	1.98	0.16	1.68	64,800	27	86,100
SB8-137-...x.../W	1-3/8	6	8	12	2.23	1.10	6	5/16	2.23	0.20	2.03	73,800	49	98,100
SB8-150-...x.../W	1-1/2	6	8	12	2.35	1.10	8	5/16	2.35	0.20	2.03	88,500	44	117,700
SB8-162-...x.../W	1-5/8	6	8	12	2.47	1.10	10	5/16	2.47	0.20	2.03	106,100	42	141,100
SB8-175-...x.../W	1-3/4	5	8	12	2.73	1.40	8	3/8	2.73	0.25	2.49	119,200	69	158,500
SB8-187-...x.../W	1-7/8	6	8	12	2.98	1.45	8	7/16	2.98	0.25	2.60	145,900	95	194,000
SB8-200-...x.../W	2	4.5	8	12	3.20	1.45	8	7/16	3.20	0.25	2.60	157,300	102	209,200
SB8-225-...x.../W	2-1/4	4.5	8	12	3.45	1.45	10	7/16	3.45	0.25	2.60	207,100	108	275,400
SB8-250-...x.../W	2-1/2	4	8	12	3.94	1.80	8	9/16	3.94	0.31	3.26	220,200	180	292,800
SB8-275-...x.../W	2-3/4	4	8	12	4.20	1.80	10	9/16	4.20	0.31	3.26	272,600	178	362,500
SB8-300-...x.../W	3	4	6	8	4.47	1.80	12	9/16	4.45	0.31	3.26	333,700	182	443,800
SB8-325-...x.../W	3-1/4	4	6	8	4.70	2.20	14	9/16	4.70	0.31	3.61	403,000	188	535,900
SB8-350-...x.../W	3-1/2	4	6	8	4.95	2.20	16	9/16	4.95	0.31	3.61	479,500	196	637,700
SB8-375-...x.../W	3-3/4	4	6	8	5.44	2.35	14	5/8	5.44	0.38	4.01	545,700	302	725,700
SB8-400-...x.../W	4	4	6	8	5.70	2.35	16	5/8	5.70	0.38	4.01	630,900	305	839,000
SB8-425-...x.../W	4-1/4	4	6	8	5.94	2.35	16	5/8	5.94	0.38	4.01	741,800	359	986,500
SB8-450-...x.../W	4-1/2	4	6	8	6.22	2.35	18	5/8	6.22	0.38	4.01	839,600	361	1,116,600
SB8-475-...x.../W	4-3/4	4	6	8	6.44	3.00	18	5/8	6.44	0.38	4.76	907,200	390	1,206,500
SB8-500-...x.../W	5	4	6	8	6.70	3.00	20	5/8	6.70	0.38	4.76	1,008,000	390	1,340,600
SB8-525-...x.../W	5-1/4	4	6	8	6.94	3.00	20	5/8	6.94	0.38	4.76	1,008,000	390	1,340,600
SB8-550-...x.../W	5-1/2	4	6	8	7.20	3.00	20	5/8	7.20	0.38	4.76	1,008,000	390	1,340,600
SB8-575-...x.../W	5-3/4	4	6	8	7.44	3.00	20	5/8	7.44	0.38	4.76	1,008,000	390	1,340,600
SB8-600-...x.../W	6	4	6	8	7.69	3.00	20	5/8	7.69	0.38	4.76	1,008,000	390	1,340,600

* All preload and torque values are provided for general reference. Applied preload plus additional bolt load from service should not exceed the maximum bolt or stud capacity. Contact your local Nord-Lock sales office for assistance in determining proper preload and torque settings for your application.
- Other sizes, thread pitches or thread per inch (TPI) may be available.
- Dimensions listed are representative.